



Free Questions for PCCSE by certsinside

Shared by Horton on 05-09-2022

For More Free Questions and Preparation Resources

Check the Links on Last Page

Question 1

Question Type: MultipleChoice

A customer has Prisma Cloud Enterprise and host Defenders deployed

What are two options that allow an administrator to upgrade Defenders'? (Choose two)

Options:

- A) generate a new DaemonSet file
- B) auto deploy the Lambda Defender
- C) click the update button in the web-interface
- D) with auto-upgrade, the host Defender will auto-upgrade.

Answer:

A, D

Question 2

Question Type: MultipleChoice

The administrator wants to review the Console audit logs from within the Console Which page in the Console should the administrator use to review this data, if it can be reviewed at all?

Options:

- A) The audit logs can be viewed only externally to the Console
- B) Navigate to Monitor > Events > Host Log Inspection
- C) Navigate to Manage > View Logs > History
- D) Navigate to Manage > Defenders > View Logs

Answer:

C

Question 3

Question Type: MultipleChoice

A customer finds that an open alert from the previous day has been resolved No auto-remediation was configured Which two reasons explain this change in alert status? (Choose two)

Options:

- A) alert was sent to an external integration
- B) resource was deleted.
- C) user manually changed the alert status
- D) policy was changed.

Answer:

B, D

Question 4

Question Type: MultipleChoice

An administrator wants to install the Defenders to a Kubernetes cluster. This cluster is running the console on the default service endpoint and will be exporting to YAML

Console Address SCONSOLE_ADDRESS

Websocket Address SWEBSOCKET_ADDRESS

User: SADMIN USER

Which command generates the YAML file for Defender install?

A)

```
<PLATFORM>/twistcli defender export kubernetes \  
--address $CONSOLE_ADDRESS \  
--user $ADMIN_USER \  
--cluster-address $WEBSOCKET_ADDRESS
```

B)

```
<PLATFORM>/twistcli defender \  
--address $CONSOLE_ADDRESS \  
--user $ADMIN_USER \  
--cluster-address $CONSOLE_ADDRESS
```

C)

```
<PLATFORM>/twistcli defender YAML kubernetes \  
--address $CONSOLE_ADDRESS \  
--user $ADMIN_USER \  
--cluster-address $WEBSOCKET_ADDRESS
```

D)

```
<PLATFORM>/twistcli defender export kubernetes \  
--address $WEBSOCKET_ADDRESS \  
--user $ADMIN_USER \  
--cluster-address $CONSOLE_ADDRESS
```

Options:

- A) Option A
- B) Option B
- C) Option C
- D) Option D

Answer:

A

Question 5

Question Type: MultipleChoice

The Unusual protocol activity (Internal) network anomaly is generating too many alerts An administrator has been asked to tune it to the option that will generate the least number of events without disabling it entirely.

Which strategy should the administrator use to achieve this goal?

Options:

- A) Change the Training Threshold to Low
- B) Disable the policy
- C) Set the Alert Disposition to Conservative
- D) Set Alert Disposition to Aggressive

Answer:

A

Question 6

Question Type: MultipleChoice

Which two processes ensure that builds can function after a Console upgrade? (Choose two)

Options:

- A) updating any build environments that have twistcli included to use the latest version
- B) configuring build pipelines to download twistcli at the start of each build
- C) creating a new policy that allows older versions of twistcli to connect the Console

D) allowing Jenkins to automatically update the plugin

Answer:

A, D

Question 7

Question Type: MultipleChoice

A business unit has acquired a company that has a very large AWS account footprint. The plan is to immediately start onboarding the new company's AWS accounts into Prisma Cloud Enterprise tenant immediately. The current company is currently not using AWS Organizations and will require each account to be onboarded individually.

The business unit has decided to cover the scope of this action and determined that a script should be written to onboard each of these accounts with general settings to gain immediate posture visibility across the accounts.

Which API endpoint will specifically add these accounts into the Prisma Cloud Enterprise tenant?

Options:

A) <https://api.prismacloud.io/accountgroup/aws>

- B) https://api.pnsmacloud.io/cloud/aws
- C) https://api.prismacloud.io/account/aws
- D) https://api.pnsmacloud.io/cloud/

Answer:

B

Question 8

Question Type: MultipleChoice

Which options show the steps are required to upgrade Console when using projects?

Options:

- A) Upgrade Defender
Upgrade Central Console
Upgrade Supervisor Consoles
- B) Upgrade all Supervisors Consoles
Upgrade Central Console

C) Upgrade Central Console
Upgrade all Supervisor Consoles

D) Upgrade Central Console
Upgrade Central Console Defenders

Answer:

C

Question 9

Question Type: MultipleChoice

A security team has been asked to create a custom policy.

Which two methods can the team use to accomplish this goal? (Choose two)

Options:

A) add a new policy

B) disable an out-of-the-box policy

- C) edit the query in the out-of-the-box policy
- D) clone an existing policy

Answer:

B, D

Question 10

Question Type: DragDrop

An administrator has been tasked with creating a custom service that will download any existing compliance report from a Prisma Cloud Enterprise.

tenant-In which order will the APIs be executed for this service? (Drag the steps into the correct order of occurrence from the first step to the last)

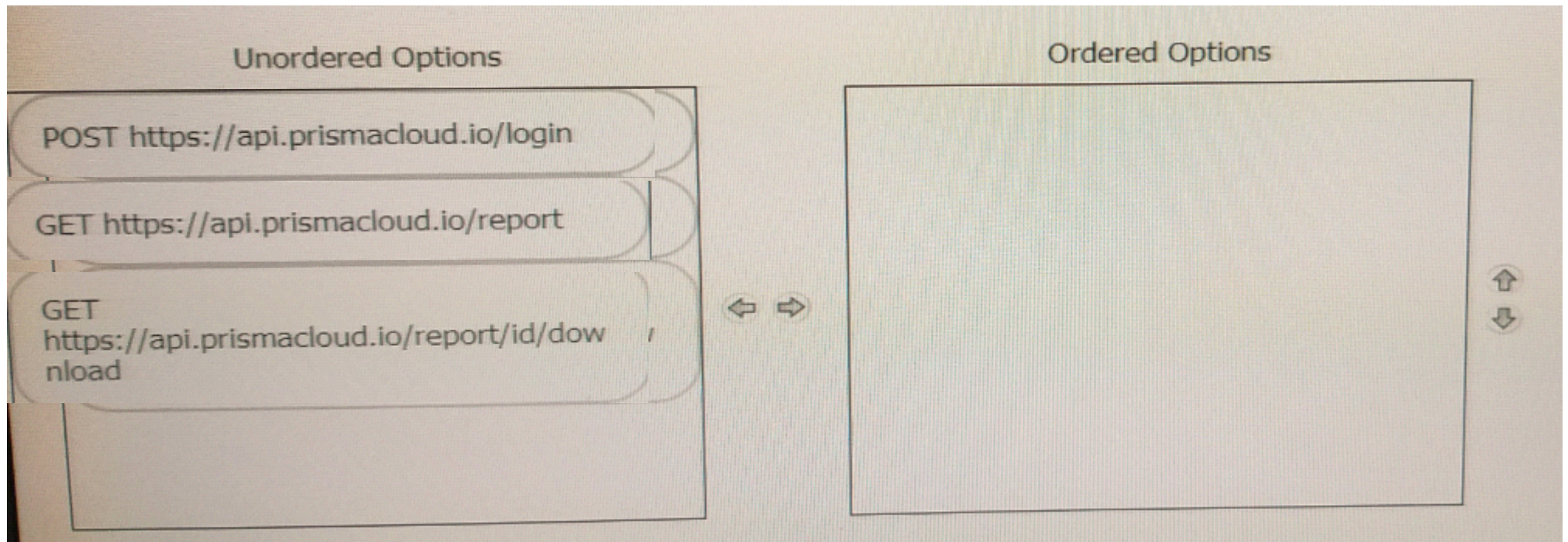

Question 11

Question Type: MultipleChoice

Per security requirements, an administrator needs to provide a list of people who are receiving e-mails for Prisma Cloud alerts Where can the administrator locate this list of e-mail recipients'?

Options:

- A) Users section within Settings.
- B) Set Alert Notification section within an Alert Rule.
- C) Notification Template section within Alerts.
- D) Target section within an Alert Rule

Answer:

A

To Get Premium Files for PCCSE Visit

<https://www.p2pexams.com/products/pccse>

For More Free Questions Visit

<https://www.p2pexams.com/palo-alto-networks/pdf/pccse>

